

Epcoco Drive Manufacturing/Warehouse
822 Epcoco Drive
Dandridge, TN 37725

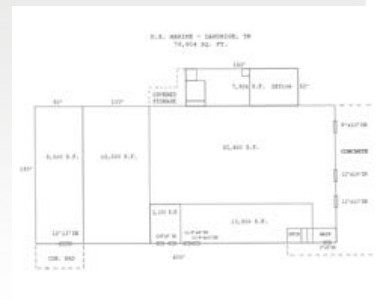

<https://tvasites.com/InSite3-local/insite3-local-rida.aspx?details=12337&Local=ETEDA>



The EPCO Building consists of approximately 5 acres improved with a 79,904 SF manufacturing/warehouse building (180 ft x 400 ft) containing 7,500 SF of office. The building was built in 1972 and expanded twice. It is constructed of pre-engineered metal with steel frame, new roof, 4-6 inch concrete floor, 12-20 ft ceiling height in the manufacturing and 16-22 ft in the warehouse, (4) loading docks, (6) drive-in doors, 200 amp-120/240 volt 3 phase electrical, gas heat, water, sewer, and gravel parking for approximately 200 cars. Located 25 miles east of Knoxville, TN, 1 mile from I-40 Exit 417 and 4 miles from I-81.

ED Contact

Jennifer Karp, Marketing Assistant
East Tennessee Economic Development Agency
10215 Technology Drive, Suite 202
Knoxville, TN 37932
Phone: 865-777-3833
Email: jkarp@eteda.org

Building Information			
Building Types:		Zoning:	Industrial
Status:	Available	Cranes:	No
Business/Industrial Park:	Jefferson County Industrial Park	Heated:	Yes
Ceiling Height:	16-22	Heat Type:	Gas
Building Size:	70,904	Air Conditioned:	No
Total Available (sq ft):	70,904	Dock:	Yes

Building Dimensions:	400' x 180'
Divisible (yes/no):	No
Expandable:	No
Office Area (sq ft):	7,500
Year Built:	1972
Primary Construction Material:	Steel
Site Size (acres):	5

Number of Truck Docks:	4
Parking:	Yes
Parking Paved:	No
Number Of Parking Spaces:	200
Multi-tenant Building:	No
Previous Tenant:	US Marine
Number of Stories:	1

Pricing Terms	
For Sale:	No
For Lease:	Yes
Lease Type:	Triple Net
Price Negotiable:	Yes
Price Per Sq Ft:	\$2.50

Geographic/Transportation Information	
Latitude:	36.032406
Longitude:	-83.425083
County:	Jefferson
Rail Access:	No
Airport Zone:	No
Foreign Trade Zone:	No
Revitalization Area:	No
Topography:	Flat
Tax Increment Financing Area:	No
Enterprise Zone:	No
Flood Plain:	No
Highway Name:	Highway 92
Distance to Highway:	0.3
Highway Name 2:	Highway 25/70
Distance to Highway 2:	1
Interstate Name:	I-40
Distance to Interstate:	0.5
Interstate Name 2:	I-81
Distance to Interstate 2:	5
Interstate Name 3:	I-75
Distance to Interstate 3:	28
Airport Name:	McGhee Tyson
Distance to Airport:	35
Airport Name 2:	Morristown
Distance to Airport 2:	15
Port Name:	Forks of the River
Distance to Port:	29
Rail Name:	Norfolk Southern
Distance to Rail:	27

Utility Information	
Service to Property (Distribution):	Yes
Electric Provider:	Appalachian Electric Coop
Amps:	2000
Electric Voltage:	120/250
KVA:	500
Electric Phase:	3
Sewer On Site:	Yes
Sewer Provider:	Dandridge Water
Sewer Main Size:	8
Septic:	No
Gas On Site:	Yes
Gas Provider:	Jefferson Cocke County Utility District
Water On Site:	Yes
Water Provider:	Dandridge Water
Telecom on Site:	Yes
DSL Available:	Yes
Fiber Optics:	Yes

Additional Information	
Region:	NE Valley





East Tennessee Economic Development Agency,
10215 Technology Drive, Suite 202, Knoxville, TN 37932 | 865-777-3833 | aclear@eteda.org

Material on this website is protected by copyright and trademark laws. The information contained in this website or linked sites is provided on an "as is" basis. We make no guarantee or representation about the accuracy or completeness of the information, and disclaim all warranties, express or implied, including but not limited to warranties of merchantability, fitness for a particular purpose and non-infringement. We are not responsible for any damages arising from the use of information on this site. It is your responsibility to independently investigate the information's accuracy and completeness, and to determine to your satisfaction the suitability of the property for your needs. Any projections, opinions, assumptions or estimates used are for example only and do not represent the current or future performance of any property.
